



ESS21182 SINK, LKB940C FAUCET



CHS17161 SINK, LKB722C FAUCET



D125223 SINK, LK5000CR FAUCET

MANUFACTURING SINKS AND FAUCETS PORTFOLIO

Together, Elkay® and Grainger® deliver reliable, commercial-grade products to support your manufacturing plumbing needs. With a wide range of sinks, faucets and filters, work in warehouses, plants and other manufacturing facilities can be done more efficiently.



CONVENIENCE

- ADA options
- Easy to clean
- Complete solutions



SUSTAINABILITY

- Made from recycled stainless steel
- Recyclable materials
- Water-saving features

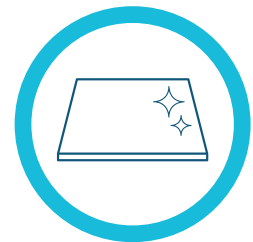

PREMIUM QUALITY

- Types 304 and 316 steel
- 14- to 20-gauge options
- American company

SINK AND FAUCET SOLUTIONS

Get dependability from our durable sinks and faucets, constructed to endure heavy-duty, high-use manufacturing tasks. They're made with Types 304 and 316 stainless steel, are easy to clean and will look like new for years to come.

Sinks

Grainger Number	Elkay Number	Description	Gauge	Overall Length	Overall Width	Bowl Length	Bowl Width	Bowl Depth	Drainboard
11U309	E1C16X20-0X	One Compartment Sink With Stainless Steel Legs	18	21"	25-13/16"	16"	20"	12"	No Drainboard
11U315	E2C16X20-0X	Two Compartment Sink With Stainless Steel Legs	18	39"	25-13/16"	16"	20"	12"	No Drainboard
11U318	E3C16X20-2-18X	Three Compartment Sink, Left and Right Drainboards and Stainless Steel Legs	18	88"	25-13/16"	16"	16"	12"	18"
11U297	RNSF8118LR2	Floor Mount, Single Compartment Scullery Sink With Drainboard	16	57"	29-3/4"	18"	24"	12-3/4"	19-1/2"
11U305	RNSF83544	Floor Mount, Triple Compartment Scullery Sink	16	67-1/2"	29-3/4"	18"	24"	12-3/4"	24"
3AEG3	D125223	Single Bowl Drop-in Sink	22	25"	22"	21"	15-3/4"	6-9/16"	No Drainboard
3AEF8	DSE233224	Equal Double Bowl Drop-in Sink	20	33"	22"	14"	15-3/4"	8-1/16"	No Drainboard
11U324	LRAD1918553	Single Bowl Drop-in ADA Sink	18	19"	18"	16"	11-1/2"	5-1/2"	No Drainboard
4YK15	LR25224	Single Bowl Drop-in Sink	18	25"	22"	21"	15-3/4"	8-1/8"	No Drainboard
4YK17	LR33224	Equal Double Bowl Drop-in Sink	18	33"	22"	14"	15-3/4"	8-1/16"	No Drainboard

Faucets

Grainger Number	Elkay Number	Description	Finish	Certification	Length	Width	Height
56UY85	LK940GN04L2H	Centerset Wall Mount Faucet With Gooseneck Spout	Chrome		6-5/8"	12-3/8"	11-3/16"
56UX53	LK69C	Commercial Wall Mount Faucet	Chrome	Tested and certified to NSF/ANSI 61 and 372	3-1/5"	2"	4"
42EJ82	LKD2439C	Centerset Concealed Deck Mount Faucet With Arc Spout	Chrome		13-1/4"	8-1/4"	16"
56VA01	LKB940C	Wall Mount Faucet With Bucket Hook Spout	Chrome		9-1/2"	12-1/4"	17-1/8"
34K021	LKB722C	Wall Mount Electronic Sensor Faucet	Chrome		7-15/16"	2-1/4"	10-7/8"

Filtration

Grainger Number	Elkay Number	Description	Capacity	Replacement	Certification
2XJ47	51299C	Replacement Filter 51299C for Sinks and Faucets	1,500 gallons	1 year after installation or after 1,500 gallons	Tested and certified to NSF/ANSI 42 and 53 for the reduction of lead, cysts, Class I particulates, and chlorine taste and odor
415C62	EF1500VRBMC	Vandal-resistant Retrofit Filtration Kit EF1500VRBMC With 1,500-gallon Lead and CTO Filter and Filter Status Monitor	1,500 gallons	1 year after installation or after 1,500 gallons	Tested and certified to NSF/ANSI 42 and 53 for the reduction of lead, cysts, Class I particulates, and chlorine taste and odor

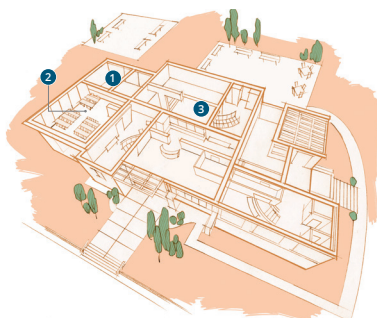

Top Products



1

Break Rooms
LRAD1918553



2

Lunchrooms
DSE233224



3

Manufacturing Floors
E3C16X20-2-18X



Ready to start your manufacturing project?
Reach out to Brandon Sonich at brandon.sonich@elkay.com.

Scan code to access and save this sheet.
Or visit elkay.com/granger

ELKAY

1333 Butterfield Road, Suite 200 Downers Grove, IL 60515 | 630.574.8484
elkay.com | ©2022 Elkay Manufacturing Company

(1/22) F-6227-ELK