



LZSTL8WSLP Bottle Filling Station/Coolers



LZ8WSSMC Bottle Filling Station



LBWDC00BKC Water Dispenser

MULTIFAMILY DRINKING WATER SOLUTIONS

Elkay® and Grainger® are two legacy brands working together to fulfill plumbing solutions for all your multifamily community projects. We offer a wide array of drinking water solutions in a variety of styles and finishes to fit your multifamily community. Let us provide you with a best-in-class experience that makes it easy to maintain your facility.



HEALTH

- Hands-free features
- Filtered solutions
- Improved hydration
- Antimicrobial material



SUSTAINABILITY

- Energy-efficient operation
- Reduced plastic waste
- Recycled and recyclable materials



CONVENIENCE

- ADA compliant
- Vandal resistant
- Indoor/outdoor options
- Complete solutions

DRINKING WATER SOLUTIONS

Built for high-traffic areas throughout the community, our trusted drinking water solutions give residents and staff access to cleaner, healthier water. Our water filters are tested and certified to NSF/ANSI standards for the reduction of lead and other harmful contaminants.

Bottle Filling Stations

| Grainger Number | Elkay Number | Description | Chilled GPH | Filtered | Cooler Cabinet Finish | Application |
|-----------------|--------------|---|-------------|----------|-----------------------|-------------|
| 39AM86 | LZS8WSLP | Single ezH2O® | 8.0 | Yes | Lt. Gray Granite | Indoor |
| 39AM89 | LZS8WSSP | Single ezH2O | 8.0 | Yes | Stainless Steel | Indoor |
| 39AM87 | LZSTL8WSLP | Versatile Bi-level ezH2O | 8.0 | Yes | Lt. Gray Granite | Indoor |
| 39AM88 | LZSTL8WSSP | Versatile Bi-level ezH2O | 8.0 | Yes | Stainless Steel | Indoor |
| 787CW5 | DSSBF8S | Floor Standing ezH2O | 8.0 | Yes | Stainless Steel | Indoor |
| 61UJ02 | LZ8WSSMC | Refrigerated Surface Mount Bottle Filling Station | 8.0 | Yes | Stainless Steel | Indoor |

Water Dispensers

| Grainger Number | Elkay Number | Description | Chilled GPH | Filtered | Color | Application |
|-----------------|--------------|---|-------------|----------|-------------|-------------|
| 55RT88 | LBWDC00BKC | ezH2O Liv® Pro Commercial Water Dispenser | No | Yes | Midnight | Indoor |
| 55RT87 | LBWDC00WHC | ezH2O Liv Pro Commercial Water Dispenser | No | Yes | Aspen White | Indoor |

Outdoor

| Grainger Number | Elkay Number | Description | Finish | Bottle Filling Stations | Bubbler Station | Application |
|-----------------|-----------------|---|------------------|-------------------------|-----------------|-------------|
| 33KJ65 | LK4420BF1UDBEVG | Outdoor ezH2O Bottle Filling Station, Bi-level with Pet Station | Vandal Resistant | 1 (Upper) | 1 (Lower) | Outdoor |
| 33KJ66 | LK4405BFEVG | Outdoor ezH2O Single Arm, Wall Mount Bottle Filling Station | Vandal Resistant | 1 | N/A | Outdoor |

Filtration

| Grainger Number | Elkay Number | Description | Capacity | Replacement | Certification |
|-----------------|--------------|--|---------------|--|--|
| 11U265 | 51300C | Replacement Filter 51300C for ezH2O Bottle Filling Stations | 3,000 gallons | 1 year after installation or after 3,000 gallons | Tested and certified to NSF/ANSI 42 and 53 for the reduction of lead, cysts, Class I particulates, and chlorine taste and odor |
| 56FK57 | 51300C_12PK | Replacement Filter 51300C for ezH2O Bottle Filling Stations, 12-pack | 3,000 gallons | 1 year after installation or after 3,000 gallons | |
| 2XJ47 | 51299C | Replacement Filter 51299C for Coolers and Fountains | 1,500 gallons | 1 year after installation or after 1,500 gallons | |
| Coming soon | ECF3000 | Replacement Filter ECF3000 for ezH2O Liv Pro Commercial Water Dispensers | 3,000 gallons | 1 year after installation or after 3,000 gallons | |
| Coming soon | ERF750 | Replacement Filter ERF750 for ezH2O Liv Residential Water Dispensers | 750 gallons | 1 year after installation or after 750 gallons | |

Elkay drinking water solutions are ADA compliant when properly installed. See product specification sheet for details.

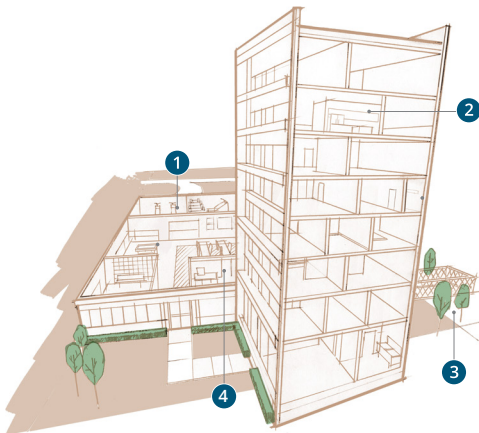

Top Products

| | | | |
|--|--|--|--|
|  1 Clubhouse/ Fitness Center LZOOTL8WSLK |  2 In-unit Kitchens LBWD00WHC |  3 Outdoor LK4420BF1UDBEVG |  4 Leasing Office LZWS-LRPBM28K and LBWDC00 |
|--|--|--|--|



Ready to start your multifamily project?
 Reach out to Brandon Sonich at brandon.sonich@elkay.com.

Scan code to access and save this sheet.
 Or visit elkay.com/granger



1333 Butterfield Road, Suite 200 Downers Grove, IL 60515 | 630.574.8484
 elkay.com | ©2022 Elkay Manufacturing Company

(rev. 1/22) F-5211-ELK